

S77-2561-W0

Tablet Holder for Dynamic Cart



[Product Description]

Specially arranged Holder that works as a platform to mount a smartphone/tablet on Dynamics Cart F-2 (C15-1624-W0) through Ball-head.

Data associated with the cart's motion if apps related to physics are installed will be easily collected and analyzed.

[Precaution]

- ✓ When using Ball-head alone, do not load anything beyond the max loading weight of 1000 g.
- ✓ Do not try to clamp anything on the Holder beyond the max loading weight of 500 g.

[Overall Advantages to Users]

- ✓ Live measured data associated with cart's motion (time, velocity, acceleration, distance, etc.) can be simultaneously/graphically displayed on the smartphone/tablet.
- ✓ Video/photo image from an unusual viewpoint is possible as if the user is on board of the cart.
- ✓ A digital camera can be easily mounted on Ball-head thanks to U1/4 screw.

[Specifications]

- Ball-head
 - Screw: U1/4
 - Movable round plate: dia. 33 mm
 - Max loading weight: 1000 g
- Holder (for smartphone/tablet)
 - Two steps expandable spring mechanism
 - Max length: 220 mm
 - Min length: 95 mm
 - Weight: 60 g
 - Max loading weight: 500 g
 - Screw hole: U 1/4 x 2
 - With latch mechanism
- Double Head Stud
 - Size: $\phi 15 \times 20$ mm
 - Screw: U1/4

[How to set up]

1. Fix Ball-head by the screw on the side.
2. Screw Stud into Ball-head.
3. Screw Ball-head into the top of the cart.

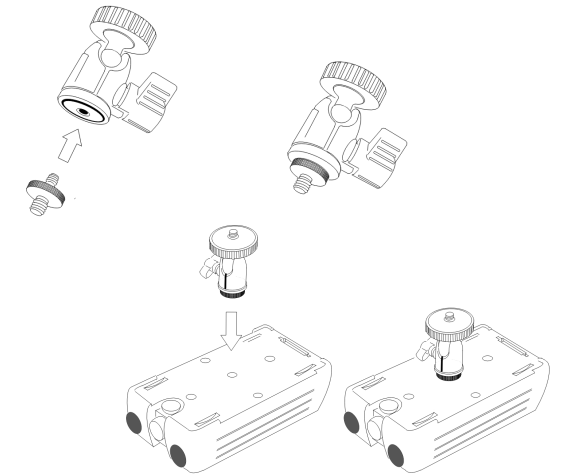

4. Screw the movable round plate of Ball-head into either of the two holes threaded on the back and side surface of Holder.
5. Clamp your smartphone/tablet on Holder.

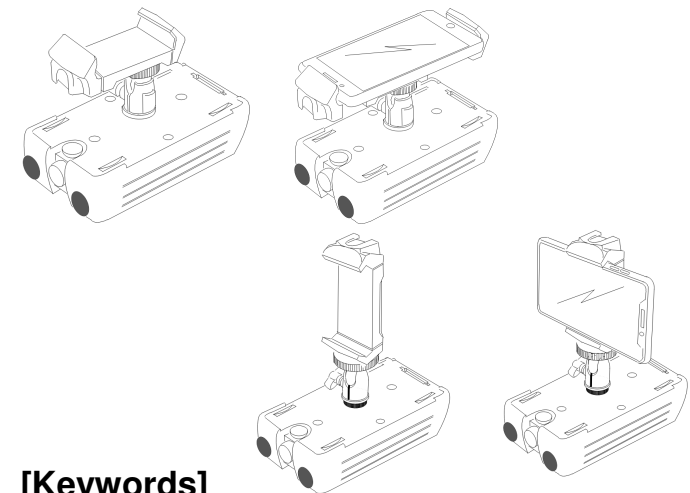

[Keywords]

*Dynamic Cart *ICT
*Smartphone
*Tablet

May 2023