

Portable Microscope LED D20-2112-W0 Instruction manual

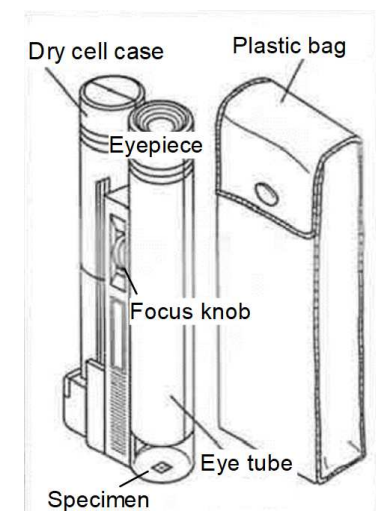

Product Feature

- "Portable Microscope" with thirty (30x) magnification and with a built-in light (LED).
- A blue filter for color correction in the microscope makes high contrast observation possible.
- Easy to carry thanks to a compact design and plastic bag.



NaRiKa Corporation
www.global.narika.jp

Caution



- Do not disassemble



- A soft cloth must be used for lens cleaning.



- Do not use chemicals to clean this product.

Observation of a specimen

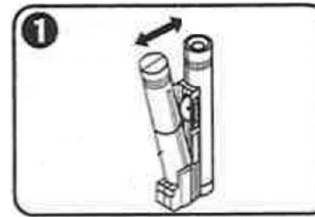

1. Move the dry cell battery case from the eye piece to turn the LED on.

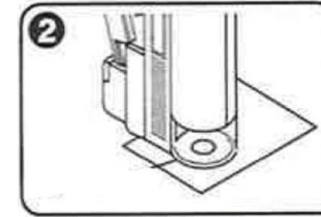

2. Place a specimen under the objective lens tube.

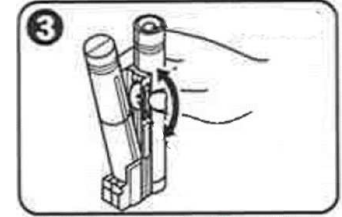

3. Adjust a focus using the focus knob to observe.

Usage example

The Portable Microscope can be used for observation of a micro-organism, a botanical, or a mineral specimen in a lab and outdoor.



Specification

- LED bulb: 2.2 V, 0.25 A
- Power supply: AA type Dry cell x 2 pcs (included)
- Magnification: 30x times

Attention



Do not rough handle the microscope like turning forcibly the focus knob. No disassembly: disassembling might cause breakdown or injury, therefore do not disassemble the product.

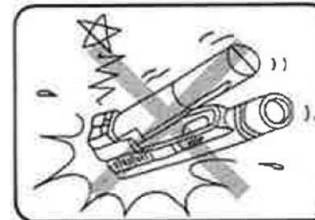

Do not expose to strong shocks or do not throw with it. The microscope lens will be damaged, or its plastic body broken due to the impact.

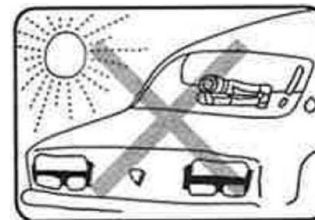

Do not leave or store the product on places with high temperatures like under blazing sun inside a car or under strong direct sunlight. It might cause deformation or breakdown of the product.

Set dry cell batteries in the case

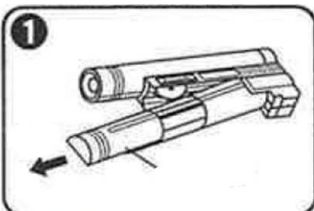

1. Slide the cover of the dry cell battery case to open.

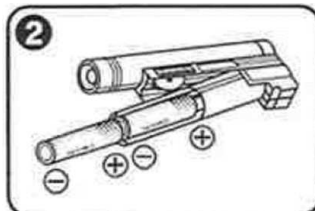

2. Insert dry cell batteries into the case, be careful about the correct polarity.

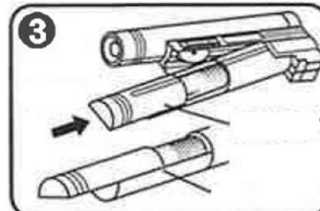

3. Close the cover.